

#22869

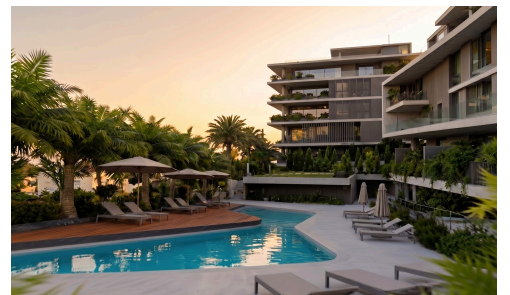

Modern 2 Bedroom 3rd Floor Apartment in Quiet Panthea Area

€465,000 +VAT

 Panthea, Limassol

For sale: A spacious off-plan apartment in the sought-after area of Panthea, offering a modern lifestyle with comfort and convenience. This third-floor home enjoys 81 m² of well-designed internal space, featuring two bedrooms and two bathrooms. The open-plan living area leads to large windows, providing both city and country views. High-quality finishes and a central AC system ensure year-round comfort.

Panthea is a modern residential neighborhood known for its peaceful setting and easy access to everything you

Bedrooms

 2

Bathrooms

 2

Covered

 81 m²

